

# ANL342 High Precision Pressure Level Meter



## Description

ANL342 high precision pressure water level gauge is a kind of hydrological instrument used for water level and water temperature measurement. Its input structure is sealed with stainless steel, and its product series are rich. It is widely used in water level and water temperature measurement in industrial processes, mines, hydrology and water conservancy, geological exploration, and other industries.

## Specifications

Range	Water Level: 0 ~ 10mH <sub>2</sub> O...200mH <sub>2</sub> O
	Temperature: 0 ~ 70°C
Overload	2 times of pressure range
Power Supply	3.8 ~ 30VDC
Output	4-wire RS485 (Modbus RTU standard protocol)
Accuracy	±0.05% FS (Level ) ±0.2°C (Temperature)
Long-term Stability	±0.05%FS/ Year
Temperature Resolution	0.01°C
Temperature Excursion	Zero: < 0.005%FS/°C
	Full Scale: < 0.005%FS/°C
Compensation Temp.	0 ~ 50°C
Operation Temp.	-10°C ~ 80°C
Storage Temp.	-40°C ~ 125°C
Protection Class	IP68 (B2)
Media Suitability	Media should be compatible with 316L and FKM
Shell Material	Stainless Steel 316L
Cable	∅ 7.6mm, with air hole shielding layer, customizable length
Insulation	100MΩ@50V

## Features

- High stability and quality
- Integrated measurement of water level and temperature
- Full range digital calibration, temperature error in full temperature range
- Strong anti-interference, surge-proof, reverse power protection
- All stainless steel sealing structure, IP68 protection

## Applications

- Industrial process
- Hydrology, water conservancy and mining
- Geological prospecting

## Size (mm)

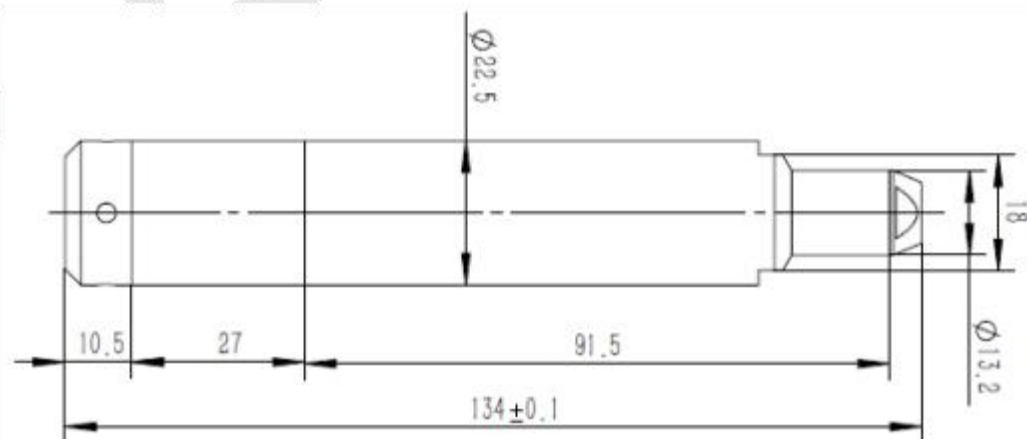

## Electrical Connection

Functional Definition	Definition	B2( Cable )
4-wire(RS485)	Positive(V+)	Red
	Negative(GND)	Yellow
	RS485A	Blue
	RS485B	Green

## Selection Guide

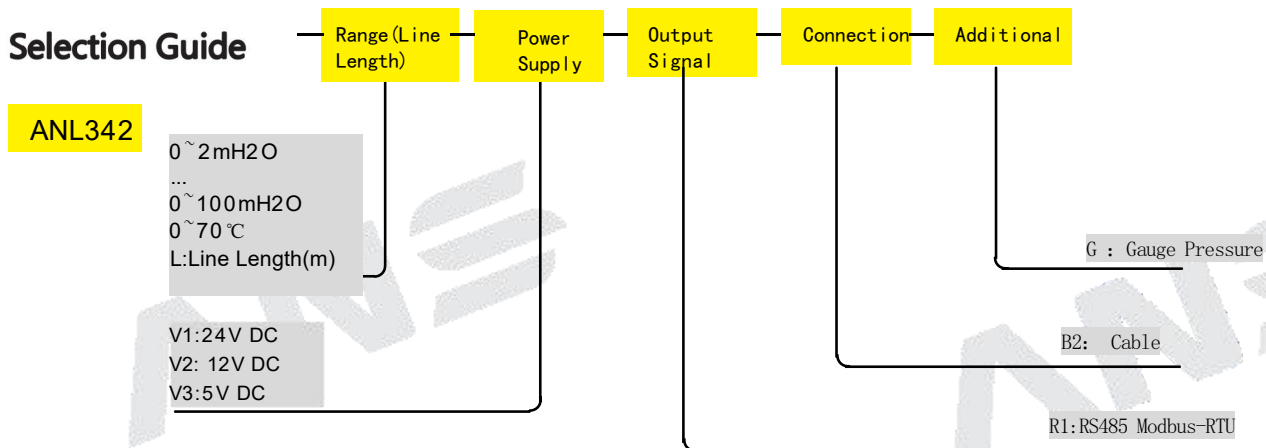

## Noted:

- Please pay attention that the media should be compatible with the contacted parts.